

Landing or Taxi LED light with WigWag function



Specification

Dimensions (mm):	83,3 mm x 47,2 mm x 37 mm
Dimensions (inches):	3.280" x 1.860" x 1.457"
Weight:	220g / 7.76 oz
Operating Voltage Range:	18 – 36 VDC
Primary Input Voltage:	28 VDC
Input Current (@18V):	1.2 A (+/-5%)
Input Current (@28V):	0.75 A (+/-5%)
Output Power:	18 W
Ambient Temperature:	from -55°C to +85°C from -67°F to +185°F
Overheat Protection:	Yes
Taxi Lens – Viewing Angle:	40° x 20°
Landing Lens – Viewing Angle:	12°
Reverse Polarity Protection	Yes
Over-Voltage Protection:	80V (1s)
Over-Voltage Lockout:	38.5 VDC
Under-Voltage Protection:	Yes
Waterproof, Dust-proof, Shock-proof, Vibration-proof:	Yes

Drawing

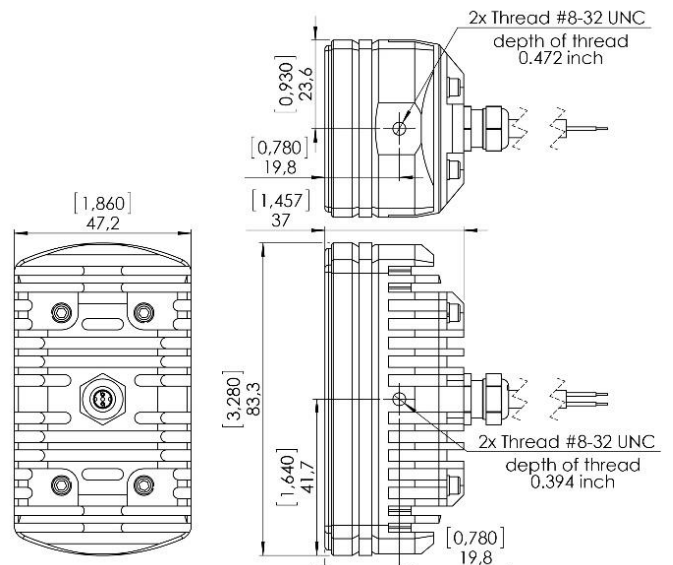

Wiring Diagram

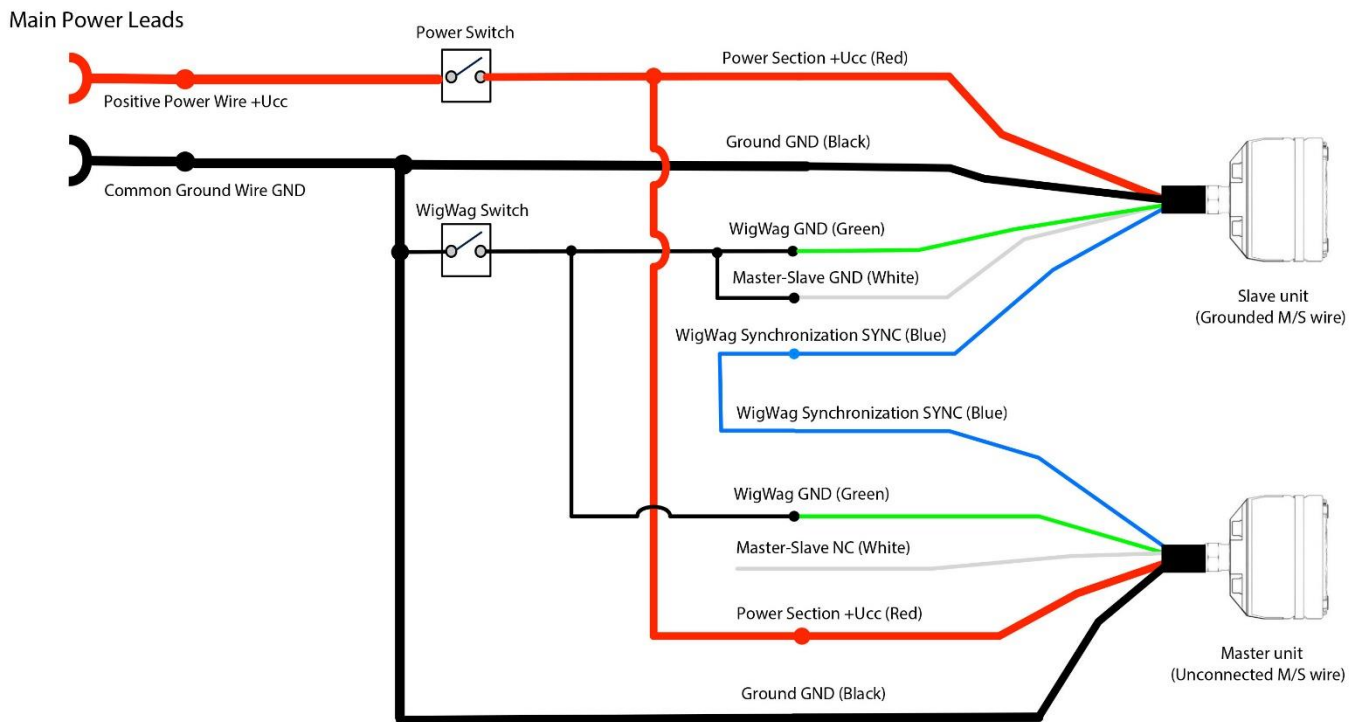

Landing lens

55 000 Cd

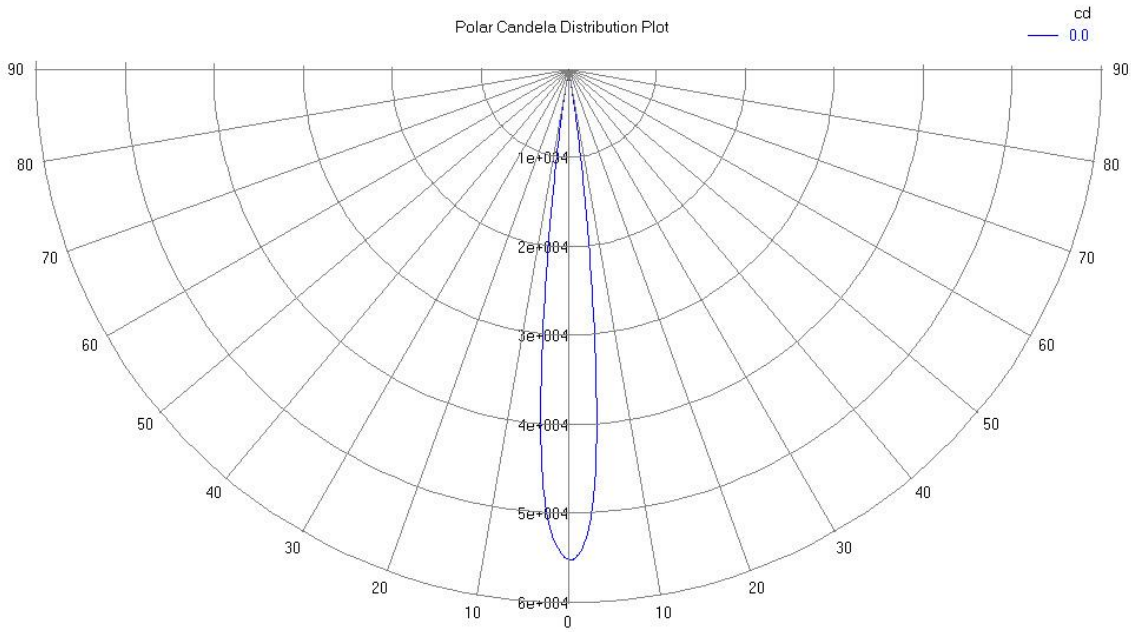

Taxi lens

9 500 Cd

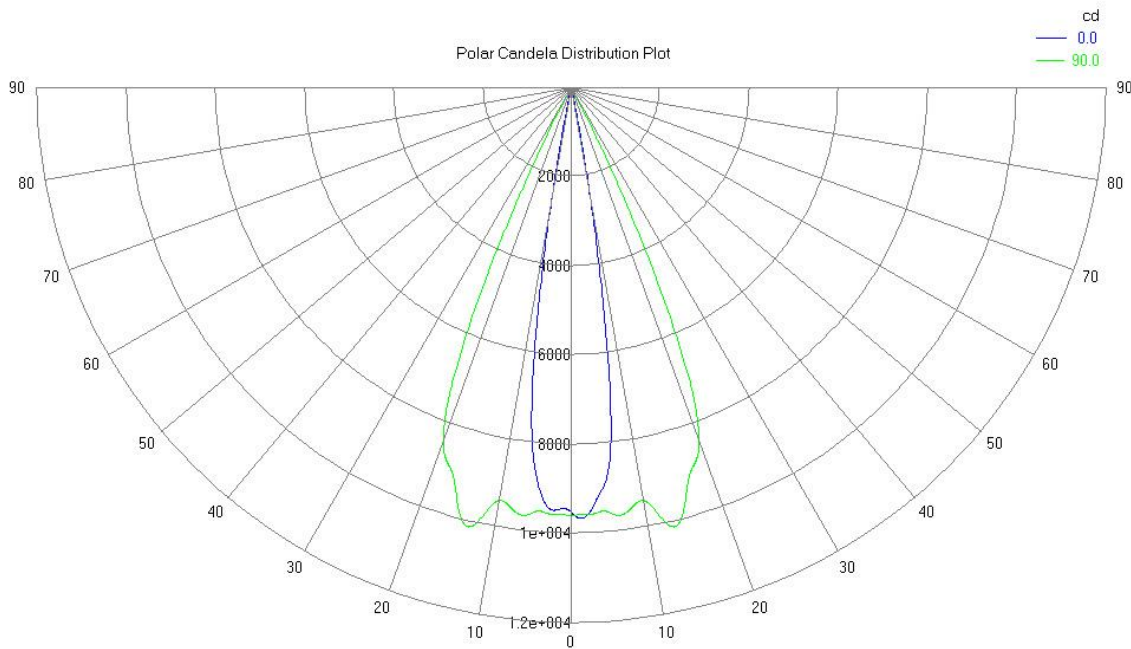

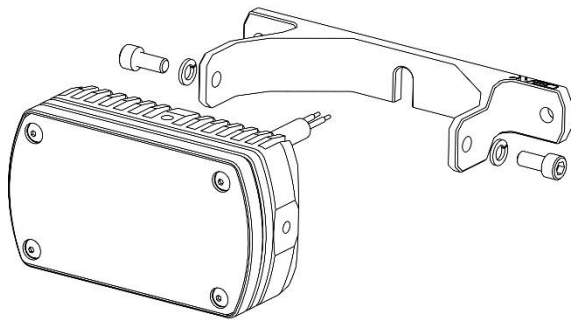

Horizontal bracket

(optional)

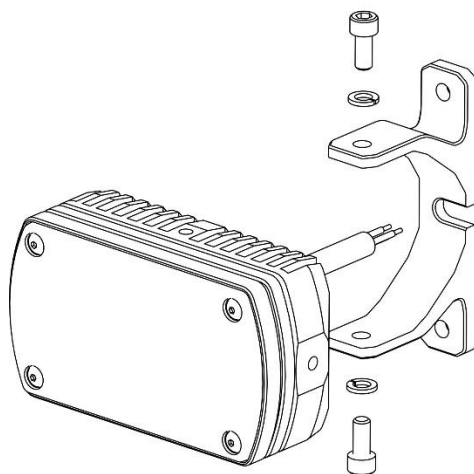
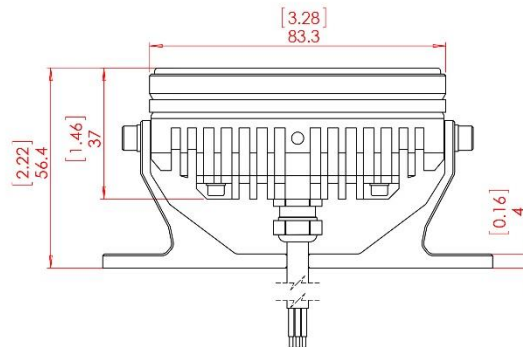
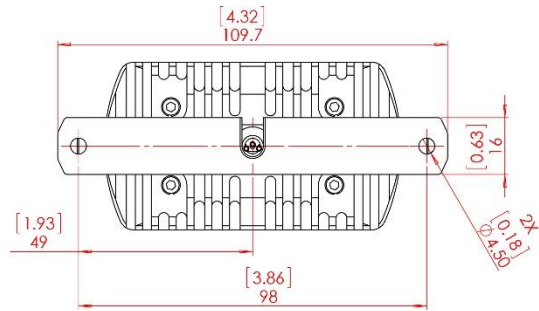

Vertical bracket

(optional)

